



CITY OF SNOHOMISH

116 UNION AVENUE · SNOHOMISH, WASHINGTON 98290 · (360) 568-3115 · WWW.SNOHOMISHWA.GOV

DECK PERMIT SUBMITTAL CHECKLIST

ALL SUBMITTALS **MUST** BE COMPLETE

- Building/Construction Permit Application
- 3 copies** of a Site Plan, showing the following information:
 - All property lines and their dimensions
 - Location of all existing structures
 - Location of all easements
 - Distances in feet from the proposed deck to all property lines
- 3 copies** of deck design drawings, showing the following information:
 - Square footage of deck
 - Type of materials that will be used to construct the deck
 - Structural details

IF LOCATED IN THE HISTORIC DISTRICT, THE FOLLOWING ITEMS ARE ALSO REQUIRED:

- 3 copies** of Photos of proposed deck location
- 3 copies** of Color renderings of materials that will be used
- 3 copies** of 8½" x 11" reductions of all larger drawings

NOTE:

The property owner is responsible for verifying property lines and all setbacks (SMC Section 19.04.500B). Applicant shall show and verify the location of property lines on the site plan. In some cases, a recorded Survey may be required by the Building Official.

DESIGN REVIEW BOARD:

The Design Review Board (DRB) reviews all deck permits within the Historic District. Initial review will be performed by one member of the DRB. If the Board member finds that the proposed deck is consistent with the design standards and guidelines, no further review by the Board is necessary. However, approval by the DRB is considered a pre-approval only. Approval by the Building Official is required.

See example of Site Plan and Details attached



CITY OF SNOHOMISH

116 UNION AVENUE · SNOHOMISH, WASHINGTON 98290 · (360) 568-3115 · WWW.SNOHOMISHWA.GOV

EXAMPLE OF AN ACCEPTABLE SITE PLAN

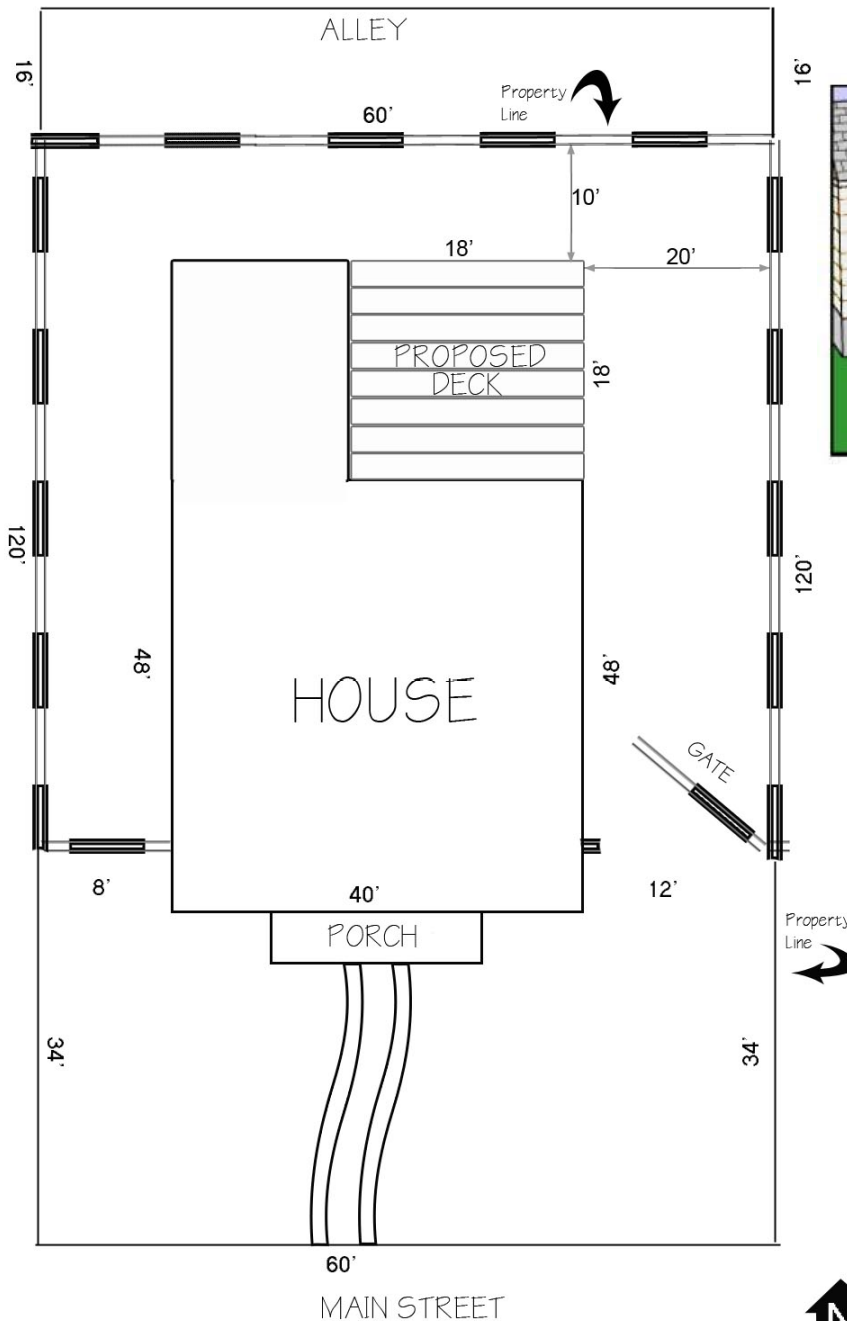

EXAMPLE OF DECK DETAIL

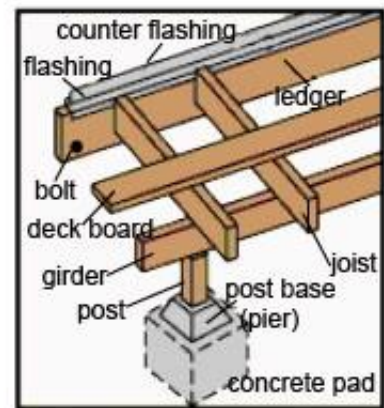

STREET ADDRESS

scale =

